

AGENDA

HIGHWAY, INFRASTRUCTURE & RECREATION COMMITTEE

DATE: Thursday, October 2, 2025
TIME: 8:00 AM
PLACE: Highway Office – Conference Room

Join by phone

+1-408-418-9388 United States Toll
Access code: 2483 345 7081

Join by WebEx App or website

<https://woodcountyiwi.webex.com/woodcountyiwi/j.php?MTID=m4eb6e2c003ec0f4a29b1218173bd5fe5>

Webinar number: 2483 345 7081
Webinar password: 100225

1. Call meeting to order
2. Declaration of quorum
3. Public comments
4. Correspondence
5. Approve minutes from previous committee meeting
6. **HIGHWAY**
 - a. Highway staff reports
 - b. Highway revenue report
 - c. Highway vouchers
 - d. 2026-2030 CIP
 - e. US 10 & STH 186
 - f. Revise Access Ordinance to include Building Set Back Lines Resolution
 - g. Review and discussion on Highway Department Draft Budget
 - h. CTH A driveway
7. **PARKS AND FORESTRY**
 - a. Parks & Forestry staff reports
 - b. Special Use permits
 - c. Parks, Recreation, and Open Spaces Plan Update draft
 - d. Accessible Hunting Blinds: Rules, Reservation Policy, and Discussion
 - e. Nekoosa Marsh Road Cranberry Land Trade Resolution
 - f. Parks and Forestry revenue reports
 - g. Parks & Forestry vouchers
8. Attendance at Meetings
9. Future Agenda Items
10. Set next regular meeting date: Thursday, November 6, 2025, 9:00 AM
11. Adjournment

NOTE: The committee may go on a Parks, Forestry, and Highway Tour immediately following the conclusion of meeting. No committee action will take place.

MINUTES

HIGHWAY, INFRASTRUCTURE & RECREATION COMMITTEE

DATE: Thursday, September 4, 2025
TIME: 9:00 AM
PLACE: Highway Dept., Conference Room

MEMBERS PRESENT: Jake Hahn, Al Breu, Scott Brehm, Lee Thao, John Hokamp

OTHERS PRESENT: Trent Miner, County Clerk, see attached sign-in sheet

1. Chairman Hahn called the meeting to order at 9:00 AM and declared a quorum present.
2. There was no public comment.
3. The minutes of the previous meeting was presented. Motion by Brehm/Hokamp to accept the minutes as corrected. Motion carried unanimously.
4. The Highway Dept. staff reports were highlighted and reviewed.
5. A licensing agreement with Wilderness Cranberry was reviewed and discussed, whereby allowing the use of a small strip of county forest land that was encroached on by a cranberry marsh when built many years ago. Motion by Breu/Brehm to approve the licensing agreement as presented. Motion carried unanimously.
6. A proposed land trade of county forest from the Nekoosa Marsh Road Cranberry Co., was reviewed with the committee. The appropriate steps are being taken and in progress, but nothing is final as of yet. Committee consensus was to continue moving forward with the required steps.
7. The Highway revenue report was reviewed.
8. Motion by Brehm/Thao to approve the Highway Dept. vouchers. Motion carried unanimously.
9. Highway Commissioner Hawk reviewed the county set back rules that have been in place with the subdivision ordinance passage of 1969. In order for this to be enforceable with the highway department, it is recommended that it become a part of the highway access ordinance. Hawk will be working on this and have a draft to review at the next meeting.
10. Hawk & Accounting Supervisor Peckham reviewed the current status of the 2026 Highway Dept. budget and the variance associated with it. They will continue to work with Finance to come up with a finalized budget that fits more into the parameters.
11. The Parks & Forestry staff reports were reviewed.
12. Schooley gave an update on the status of the Powers Bluff shelter building project, which has begun. He is also meeting with a trail advisor about enhancing the trails at the top of the hill given its historical nature.

13. Schooley gave a report on the current status of CERA Park. A new roof is slated to be put on the shelter house yet this year.
14. The Parks & Forestry revenue reports were reviewed.
15. Motion by Hokamp/Thao to approve Parks & Forestry vouchers. Motion approved unanimously.
16. The committee reviewed the action of the Operations Committee as it relates to the Maintenance Supervisor position upgrade request.
17. The 2026 Parks & Forestry budget administration budget was presented and reviewed by the committee. Explanations were offered for variances.
18. The next meeting will be held on Thursday, October 2nd, at 8:00 AM at the Highway Department Conference Room.
19. Chairman Hahn declared the meeting adjourned at 10:39 AM.

Minutes taken by Trent Miner, County Clerk, and are in draft form until approved at the next meeting.

September 4, 2025

4



Wood County WISCONSIN

OFFICE OF
HIGHWAY COMMISSION

Roland Hawk
COMMISSIONER

September 25, 2025

To: Highway, Infrastructure & Recreation Committee

From: Roland Hawk, PE Highway Commissioner

Subject: Commissioner Report for October 2, 2025, HIRC meeting

Department Activities

Personnel/Administration

The Highway Department currently has no vacancies.

The Commissioner proposes revising the access policy as discussed at the September HIRC to incorporate the same building setback distances as described in the Planning & Zoning Land Division Ordinance.

Highway staff are working with IT and Delasoft in preparation for a new online permitting software. Anticipate the new program to go live in November or December 2025.

Commissioner and staff have been working on the proposed 2026 budget and project list. We are considering revisions to maintenance plan and impacts to level of service.

A Grand Rapids resident purchased a property through a sheriff's sale next to Lake Wazeecha Park property. The previous owners installed a septic field that is partially on County owned land. The County parcel was obtained in 1946 for "street purposes." The resident has requested the Highway Department and/or Park Department to consider selling a portion of this parcel (currently vacant) so the property owner's septic can be on privately owned land. Commissioner is working with Corporation Council to find a way to resolve the issue.

Wisconsin Department of Transportation is evaluating intersection alternatives for 8th Street and Griffith Ave, (Wis 13 & CTH Z). Options being evaluated will require both the County and City of Wisconsin Rapids to have some cost sharing. The project is currently scheduled for construction in 2027.

Highway/Facility Projects

- WisDOT STP Project CTH F & HH Intersection **Construction 2026**
 - R/W acquisition complete.
 - Utility relocations in progress.
 - Project will be LET for Bids November 2025
- WisDOT STP Bridge CTH N (STH 186 – CTH N) **Construction 2025**
 - LET for Bids on 12-10-24 (\$416,823) Pheifer Brothers Construction Co
 - Issues with ATC and scheduled power outage, DOT considering moving to 2026.
- WisDOT STP Urban (BIL) CTH U Village of Biron **Construction 2026**

- Design Complete, working on final plans for Bidding.
- Final R/W parcel purchased 9/24/25. Need to Raise the structure during winter 2025.
- Borrow site (pond) started 9/22/2025, anticipate completion by 10/2/2025..
- Box culvert installation completed 9/19/2025
- CTH BB Realignment Project
 - Project completed August 2025
- CTH AA Lynn Creek
 - Preliminary Road & Structure Plans 90% complete.
 - Preliminary Estimate \$1.9 million
 - Commissioner exploring funding options
 - Commissioner reassigned \$139,651 LRIP funds to the Lynn Creek Bridge replacement
- Marshfield Facility Fueling Station
 - Work began July 29, anticipating completion by 10/24/2025.

Highway Maintenance

Work in September included:

- Sign replacements
- Culvert replacements
- Mowing roadside vegetation
- Bridge repairs, CTH F in Town of Sherry
- Pavement marking
- Ditching & drainage maintenance

WCHA Events & Misc. Meetings since the last HIRC meeting

Commissioner attended the following events/meetings:

- September 4 – NACE NC Region Quarterly Meeting, Virtual
- September 10 – WisDOT Bridge Inspection Quality Assurance Review
- September 10 – Traffic Safety Commission Meeting, Highway Conference Room
- September 11 – Meeting with resident on CTH BB regarding speed limit and intersection site distance
- September 11 – Meeting with City of Wis Rapids regarding 2026 projects
- September 16 – County Board Meeting
- September 17 – NC Region Commissioner Meeting, Merrill, Lincoln County
- September 18 – CTH AA Progress Meeting, Virtual
- September 19 – Stadt Road Bridge abutment pre-pour meeting, Virtual
- September 22 – WisDOT LRIP web training, Virtual
- September 23 – 24, NACE BOD Meeting/ Short Span Steel Bridge Alliance Conf. Indianapolis, IN.
- September 24 – Operations Committee, Budget Meeting,

EQUIPMENT

A new high-capacity brine maker will be installed at the Marshfield facility likely in November 2025. WisDOT is providing 100% of the funding to purchase the brine maker and equipment.

WisDOT has also committed to funding 60% of a new salt shed to be constructed on the Dexterville site located near the intersection of STH 80 and STH 54. The WisDOT funding is available as part of their FY 2026 budget. The Highway Department will be requesting \$300,000 for the County's share of the salt shed in the 2027 budget and will be preparing the site for construction starting in late 2026..

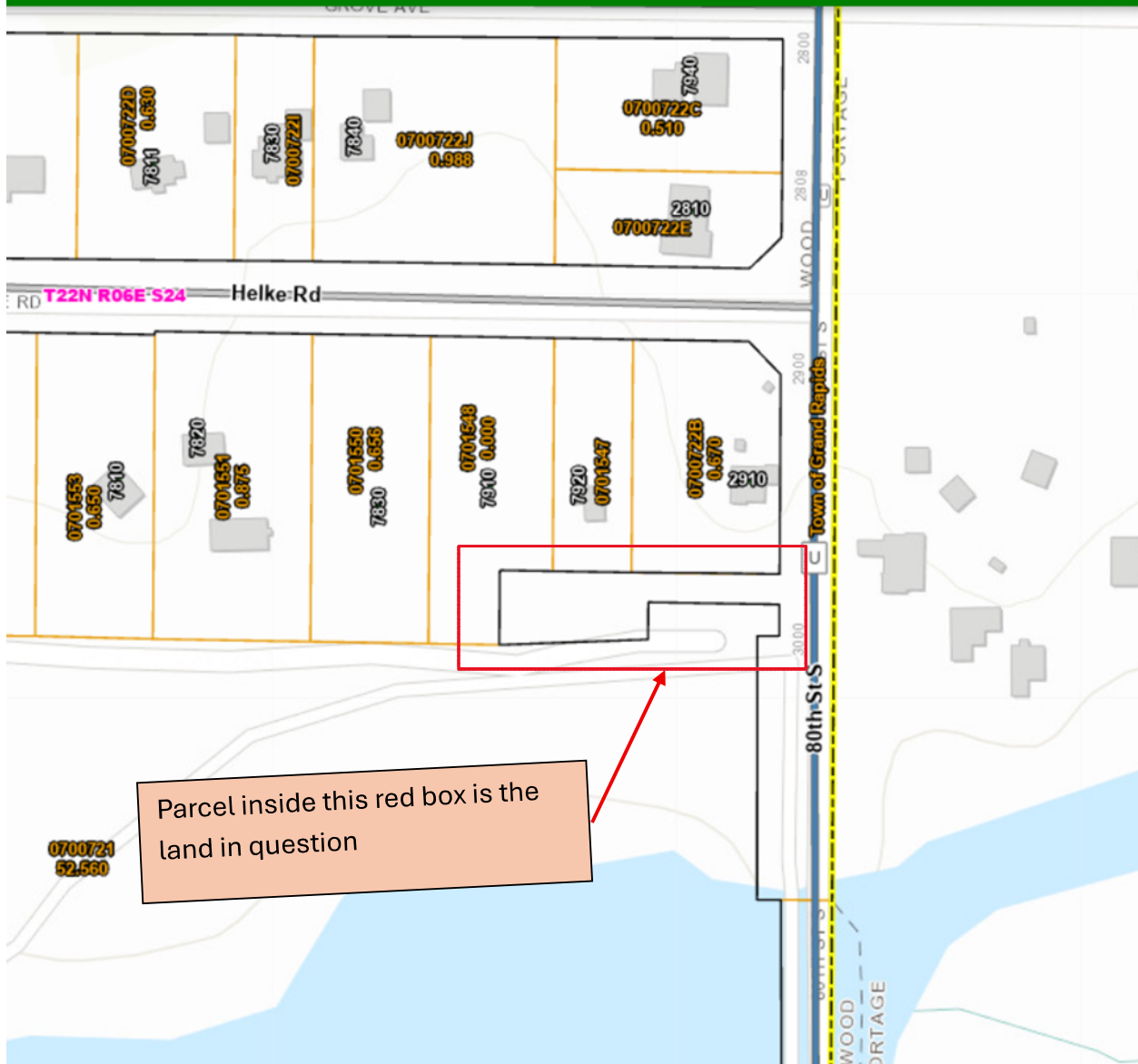

Accounting Supervisor Report

By John Peckham, Wood County Highway Department Accounting Supervisor

HIRC Meeting

Revenues and Expenses

We have done a number of Road and Bridge Aid projects that bump up revenues as the invoices are approved and sent. Crews are continuing to work, as well, on some State Discretionary Maintenance projects. Revenues from all those projects will be booked as the projects are completed.

We will receive the final GTA payment from the State soon.

County construction projects continue to wind down.

Other

At the time of the HIRC meeting, Jake, Roland, and I will have met with the Operations Committee and received direction on the 2026 budget.

County of Wood
DETAILED INCOME STATEMENT W/SUBTOTALS
 Highway Departmentwide
 Tuesday, September 30, 2025

		2025		
		Actual	Budget	Variance
				Variance %
REVENUES				
Intergovernmental Revenues				
43300	Federal Grants-American Recovery & Reinvest Act	\$172,714.73	\$400,000.00	(\$227,285.27)
43531	State Aid-Transportation	1,909,049.31	2,497,341.00	(588,291.69)
43534	State Aid-LRIP	470,745.05	844,061.00	(373,315.95)
	Total Intergovernmental	2,552,509.09	3,741,402.00	(1,188,892.91)
Licenses and Permits				
44101	Utility Permits	24,002.50	30,550.00	(6,547.50)
	Total Licenses and Permits	24,002.50	30,550.00	(6,547.50)
Intergovernmental Charges for Services				
47230	State Charges	1,337,870.14	1,264,109.00	73,761.14
47231	State Charges-Highway	213,040.47	268,014.00	(54,973.53)
47232	State Charges-Machinery	26,423.91	(14,629.00)	41,052.91
47300	Local Gov Chgs	340,613.74	848,896.00	(508,282.26)
47330	Local Gov Chgs-Transp	894,862.05	1,964,726.00	(1,069,863.95)
47332	Local Gov Chgs-Roads	128,023.61	267,134.00	(139,110.39)
47333	Local Gov Chgs-Bridges	41,844.99	117,697.00	(75,852.01)
	Total Charges to Other Governments	2,982,678.91	4,715,947.00	(1,733,268.09)
Interdepartmental Charges for Services				
47470	Dept Charges-Highway	1,835,604.11	2,731,559.00	(895,954.89)
	Total Interdepartmental Charges	1,835,604.11	2,731,559.00	(895,954.89)
	Total Intergovernmental Charges for Services	4,818,283.02	7,447,506.00	(2,629,222.98)
Miscellaneous				
48340	Gain/Loss-Sale of Salvage and Waste	3,744.60	10,605.00	(6,860.40)
	Total Miscellaneous	3,744.60	10,605.00	(6,860.40)
Other Financing Sources				
49110	Proceeds from Long-Term Debt		2,451,500.00	(2,451,500.00)
49280	Transfer from Trust Funds	470,745.05		470,745.05
	Total Other Financing Sources	470,745.05	2,451,500.00	(1,980,754.95)
	TOTAL REVENUES	7,869,284.26	13,681,563.00	(5,812,278.74)
EXPENDITURES				
Public Works-Highway				
53110	Hwy-Administration	311,248.21	437,391.41	126,143.20
53120	Hwy-Engineer	162,847.92	210,931.64	48,083.72
53191	Hwy-Other Administration	292,017.61	402,931.49	110,913.88
53210	Hwy-Employee Taxes & Benefits	(939,170.18)		939,170.18
53220	Hwy-Field Tools	30,322.13	(45,534.22)	(75,856.35)
53230	Hwy-Shop Operations	119,329.21	397,971.95	278,642.74
53232	Hwy-Fuel Handling	(18,526.17)	(17,766.00)	760.17
53240	Hwy-Machinery Operations	(1,431,521.04)	(71,912.30)	1,359,608.74
53250	Hwy-Crushing Operations	42,371.27	17,936.97	(24,434.30)
53251	Hwy-Crushing Operations Production	122,533.97	103,564.60	(18,969.37)
53260	Hwy-Bituminous Ops	125,114.89	214,888.22	89,773.33
53266	Hwy-Bituminous Ops	1,399,063.34	2,017,610.84	618,547.50
53270	Hwy-Buildings & Grounds	234,940.96	233,326.35	(1,614.61)
53290	Hwy-Salt Brine Operations	(8,013.70)	(1,013.49)	7,000.21
53291	Hwy-Salt Brine Operations	15,708.55	(4,800.49)	(20,509.04)
53281	Hwy-Acquistion of Capital Assets	586,599.08		(586,599.08)
53310	Hwy-Maintenance CTHS		65,522.15	65,522.15
53311	Hwy-Maint CTHS Patrol Sectn	1,601,207.20	2,296,960.44	695,753.24
53312	Hwy-Snow Remov	829,223.60	990,000.16	160,776.56
53313	Hwy-Maintenance Gang	263,459.29	217,072.03	(46,387.26)
53314	Hwy-Maint Gang-Materials	2,572.98	8,302.00	5,729.02
53320	Hwy-Maint STHS	1,432,481.01	1,264,109.05	(168,371.96)
53330	Hwy-Local Roads	1,399,092.55	1,964,726.04	565,633.49
53340	Hwy-County-Aid Road Construction	230,982.00	330,037.42	99,055.42
53341	Hwy-County-Aid Bridge Construction	90,070.84	250,731.09	160,660.25
53490	Hwy-State & Local Other Services	417,838.36	848,895.86	431,057.50
53491	Hwy-ATV Route Signage		17,346.37	17,346.37
	Total Public Works-Highway	7,311,793.88	12,149,229.58	4,837,435.70
Capital Outlay				
57310	Highway Capital Projects	3,129,676.27	3,423,665.39	293,989.12

County of Wood
 DETAILED INCOME STATEMENT W/SUBTOTALS
 Highway Departmentwide
 Tuesday, September 30, 2025

		2025		
		Actual	Budget	Variance Variance %
	Total Capital Outlay	3,129,676.27	3,423,665.39	293,989.12 8.59%
	Other Financing Uses			
59210	Transfers to General Fund	470,745.05		(470,745.05) 0.00%
	Total Other Financing Uses	470,745.05		(470,745.05) 0.00%
	TOTAL EXPENDITURES	10,912,215.20	15,572,894.97	4,660,679.77 29.93%
	NET INCOME (LOSS) *	(3,042,930.94)	(1,891,331.97)	(1,151,598.97) 60.89%

Committee Report

County of Wood

Report of claims for: HIGHWAY

For the period of: AUGUST

For the range of vouchers: 16251909 - 16252177

Voucher	Vendor Name	Nature of Claim	Doc Date	Amount	Paid
16251909	ADVANCE JANITORIAL/CLEAN POWER (Use after 7/31/25)	CARPET/FLOOR & CLEANING SVC	08/25/2025	\$718.23	P
16251910	BECKER TRUCKING & EXCAVATING INC	AGGREGATE MATERIALS	08/08/2025	\$1,836.57	P
16251911	BOHN TRUCKING & EXCAVATING INC	HOT MIX SAND	08/19/2025	\$16,365.83	P
16251912	INTEGRATED FAB TECHNOLOGIES LLC	CTH U CULVERT	08/22/2025	\$35,417.12	P
16251913	WISCO CONCRETE SOLUTIONS	CTH U	08/24/2025	\$4,969.00	P
16251914	WASTE MANAGEMENT	GARBAGE DISPOSAL	08/19/2025	\$499.72	P
16251915	WI COUNTY HIGHWAY ASSOCIATION	SNOWFIGHTER TRAINING	08/26/2025	\$1,800.00	P
16251916	UNIVERSAL TRUCK EQUIPMENT INC	3139 MACK SINGLE AXLE	08/13/2025	\$37,400.00	P
16251917	MILESTONE MATERIALS	AGGREGATES	08/18/2025	\$5,083.90	P
16251918	MILESTONE MATERIALS	AGGREGATES	08/15/2025	\$7,640.36	P
16251919	MILESTONE MATERIALS	AGGREGATES	08/15/2025	\$845.38	P
16251920	MILESTONE MATERIALS	AGGREGATES	08/18/2025	\$409.46	P
16251921	MILESTONE MATERIALS	AGGREGATES	08/20/2025	\$13,298.70	P
16251922	MILESTONE MATERIALS	AGGREGATES	08/20/2025	\$616.16	P
16251923	MILESTONE MATERIALS	AGGREGATES	08/20/2025	\$409.65	P
16251924	MILESTONE MATERIALS	AGGREGATES	08/22/2025	\$7,177.06	P
16251925	MILESTONE MATERIALS	AGGREGATES	08/22/2025	\$14,110.65	P
16251926	MILESTONE MATERIALS	HOT MIX AGGREGATES	08/22/2025	\$11,191.79	P
16251927	MILESTONE MATERIALS	AGGREGATES	08/22/2025	\$206.33	P
16251928	MILESTONE MATERIALS	AGGREGATES	08/25/2025	\$1,195.56	P
16251929	MILESTONE MATERIALS	AGGREGATES	08/15/2025	\$4,764.61	P
16251930	AMAZON CAPITAL SERVICES	OFFICE SUPPLIES	08/20/2025	\$18.98	P
16251931	AMAZON CAPITAL SERVICES	PARTS	08/25/2025	\$45.07	P
16251932	AMAZON CAPITAL SERVICES	PARTS	08/25/2025	\$143.05	P
16251933	AMAZON CAPITAL SERVICES	PARTS	08/25/2025	\$41.13	P
16251934	AT&T-ATLANTA	TELEPHONE - MFLD	08/21/2025	\$50.20	P
16251935	JJ KELLER & ASSOCIATES	JJK SUBSCRIPTION	08/26/2025	\$199.00	P
16251936	PETERS HEAVY CONSTRUCTION	CRANE - CTH U	08/30/2025	\$4,000.00	P
16251937	SOLARUS	TELEPHONE - WR & HOT MIX	09/01/2025	\$148.20	P
16251938	SPARHAWK PROPERTIES LLC	PARCEL 2 FEE, TLE ACQUISITION	08/28/2025	\$2,650.00	P
16251939	AMAZON CAPITAL SERVICES	PARTS	08/28/2025	\$19.98	P
16251940	AMAZON CAPITAL SERVICES	PARTS	09/02/2025	\$13.99	P
16251941	AMAZON CAPITAL SERVICES	PARTS	09/04/2025	\$83.88	P

HIGHWAY - AUGUST

16251909 - 16252177

Voucher	Vendor Name	Nature of Claim	Doc Date	Amount	Paid
16251942	AMAZON CAPITAL SERVICES	OFFICE SUPPLIES	09/05/2025	\$87.92	P
16251943	AMAZON CAPITAL SERVICES	PARTS	09/08/2025	\$123.23	P
16251944	ADVANCE AUTO PARTS (Wis Rapids)	PARTS	08/04/2025	(\$20.64)	P
16251945	ADVANCE AUTO PARTS (Wis Rapids)	PARTS	08/04/2025	\$157.99	P
16251946	ADVANCE AUTO PARTS (Wis Rapids)	PARTS	08/04/2025	\$196.63	P
16251947	ADVANCE AUTO PARTS (Wis Rapids)	PARTS	08/04/2025	\$33.28	P
16251948	ADVANCE AUTO PARTS (Wis Rapids)	PARTS	08/05/2025	\$184.98	P
16251949	ADVANCE AUTO PARTS (Wis Rapids)	PARTS	08/05/2025	\$65.99	P
16251950	ADVANCE AUTO PARTS (Wis Rapids)	PARTS	08/06/2025	\$190.83	P
16251951	ADVANCE AUTO PARTS (Wis Rapids)	PARTS	08/06/2025	\$17.49	P
16251952	ADVANCE AUTO PARTS (Wis Rapids)	PARTS	08/07/2025	(\$10.12)	P
16251953	ADVANCE AUTO PARTS (Wis Rapids)	PARTS	08/07/2025	(\$22.00)	P
16251954	ADVANCE AUTO PARTS (Wis Rapids)	PARTS	08/07/2025	(\$22.00)	P
16251955	ADVANCE AUTO PARTS (Wis Rapids)	PARTS	08/07/2025	\$269.34	P
16251956	ADVANCE AUTO PARTS (Wis Rapids)	PARTS	08/07/2025	\$27.86	P
16251957	ADVANCE AUTO PARTS (Wis Rapids)	PARTS	08/12/2025	\$443.60	P
16251958	ADVANCE AUTO PARTS (Wis Rapids)	PARTS	08/12/2025	\$30.41	P
16251959	ADVANCE AUTO PARTS (Wis Rapids)	PARTS	08/12/2025	\$24.99	P
16251960	ADVANCE AUTO PARTS (Wis Rapids)	PARTS	08/12/2025	\$29.98	P
16251961	ADVANCE AUTO PARTS (Wis Rapids)	PARTS	08/12/2025	\$11.22	P
16251962	ADVANCE AUTO PARTS (Wis Rapids)	PARTS	08/12/2025	\$10.21	P
16251963	ADVANCE AUTO PARTS (Wis Rapids)	PARTS	08/12/2025	\$201.25	P
16251964	ADVANCE AUTO PARTS (Wis Rapids)	PARTS	08/13/2025	\$73.99	P
16251965	ADVANCE AUTO PARTS (Wis Rapids)	PARTS	08/14/2025	(\$22.00)	P
16251966	ADVANCE AUTO PARTS (Wis Rapids)	PARTS	08/14/2025	\$16.02	P
16251967	ADVANCE AUTO PARTS (Wis Rapids)	PARTS	08/18/2025	\$46.97	P
16251968	ADVANCE AUTO PARTS (Wis Rapids)	PARTS	08/18/2025	\$212.47	P
16251969	ADVANCE AUTO PARTS (Wis Rapids)	PARTS	08/18/2025	\$24.91	P
16251970	ADVANCE AUTO PARTS (Wis Rapids)	PARTS	08/20/2025	\$9.85	P
16251971	ADVANCE AUTO PARTS (Wis Rapids)	PARTS	08/20/2025	\$21.81	P
16251972	ADVANCE AUTO PARTS (Wis Rapids)	PARTS	08/20/2025	\$27.12	P
16251973	ADVANCE AUTO PARTS (Wis Rapids)	PARTS	08/21/2025	(\$11.22)	P
16251974	ADVANCE AUTO PARTS (Wis Rapids)	PARTS	08/21/2025	\$49.42	P
16251975	ADVANCE AUTO PARTS (Wis Rapids)	PARTS	08/25/2025	\$133.72	P
16251976	ADVANCE AUTO PARTS (Wis Rapids)	PARTS	08/25/2025	\$11.81	P
16251977	ADVANCE AUTO PARTS (Wis Rapids)	PARTS	08/25/2025	\$67.62	P
16251978	ADVANCE AUTO PARTS (Wis Rapids)	PARTS	08/25/2025	\$283.80	P
16251979	ADVANCE AUTO PARTS (Wis Rapids)	PARTS	08/28/2025	\$9.83	P
16251980	ADVANCE AUTO PARTS (Wis Rapids)	PARTS	08/28/2025	\$88.23	P
16251981	ADVANCE AUTO PARTS (Wis Rapids)	PARTS	08/28/2025	\$24.00	P
16251982	ACE HARDWARE	PARTS	08/11/2025	\$58.13	P
16251983	ACE HARDWARE	PARTS	08/12/2025	\$8.59	P
16251984	ACE HARDWARE	PARTS	08/25/2025	\$60.76	P
16251985	ACE HARDWARE	PARTS	08/25/2025	\$42.97	P

HIGHWAY - AUGUST

16251909 - 16252177

Voucher	Vendor Name	Nature of Claim	Doc Date	Amount	Paid
16251986	ACE HARDWARE	PARTS	08/27/2025	\$69.99	P
16251987	APPLIED INDUSTRIAL TECHNOLOGIES INC	PARTS	08/06/2025	(\$298.35)	P
16251988	APPLIED INDUSTRIAL TECHNOLOGIES INC	PARTS	08/05/2025	\$216.37	P
16251989	APPLIED INDUSTRIAL TECHNOLOGIES INC	PARTS	08/07/2025	\$688.50	P
16251990	APPLIED INDUSTRIAL TECHNOLOGIES INC	PARTS	08/19/2025	\$10.38	P
16251991	APPLIED INDUSTRIAL TECHNOLOGIES INC	PARTS	08/25/2025	\$51.90	P
16251992	APPLIED INDUSTRIAL TECHNOLOGIES INC	PARTS	08/04/2025	\$147.72	P
16251993	APPLIED INDUSTRIAL TECHNOLOGIES INC	PARTS	08/04/2025	\$49.56	P
16251994	APPLIED INDUSTRIAL TECHNOLOGIES INC	PARTS	08/12/2025	\$533.16	P
16251995	APPLIED INDUSTRIAL TECHNOLOGIES INC	PARTS	08/21/2025	\$2,624.60	P
16251996	APPLIED INDUSTRIAL TECHNOLOGIES INC	PARTS	08/21/2025	\$201.94	P
16251997	APPLIED INDUSTRIAL TECHNOLOGIES INC	PARTS	08/21/2025	\$129.68	P
16251998	APPLIED INDUSTRIAL TECHNOLOGIES INC	PARTS	08/22/2025	\$64.49	P
16251999	APPLIED INDUSTRIAL TECHNOLOGIES INC	PARTS	08/25/2025	\$18.06	P
16252000	APPLIED INDUSTRIAL TECHNOLOGIES INC	PARTS	08/28/2025	\$1,272.06	P
16252001	ARING EQUIPMENT COMPANY	PARTS	08/28/2025	\$313.16	P
16252002	ARING EQUIPMENT COMPANY	PARTS	08/28/2025	\$315.98	P
16252003	ASCENDANCE TRUCKS CENTRAL LLC	PARTS	08/20/2025	\$293.11	P
16252004	ASCENDANCE TRUCKS CENTRAL LLC	PARTS	08/06/2025	\$274.30	P
16252005	ASCENDANCE TRUCKS CENTRAL LLC	PARTS	08/11/2025	\$142.56	P
16252006	ASCENDANCE TRUCKS CENTRAL LLC	PARTS	08/22/2025	\$62.34	P
16252007	ASCENDANCE TRUCKS CENTRAL LLC	PARTS	08/26/2025	\$427.91	P
16252008	ASCENDANCE TRUCKS CENTRAL LLC	PARTS	08/27/2025	\$62.38	P
16252009	ASCENDANCE TRUCKS CENTRAL LLC	PARTS	08/28/2025	\$758.19	P
16252010	ASCENDANCE TRUCKS CENTRAL LLC	PARTS	08/27/2025	\$114.26	P
16252011	ASPHALT MATERIALS INC	HOT MIX OIL	08/25/2025	\$10,364.85	P
16252012	BEAVER OF WISCONSIN INC	PARTS	08/28/2025	\$405.00	P
16252013	BECKER TRUCKING & EXCAVATING INC	CULVERTS	08/15/2025	\$26,324.11	P
16252014	BOHN TRUCKING & EXCAVATING INC	HOT MIX SAND	08/27/2025	\$8,943.37	P
16252015	BROOKS TRACTOR INC	PARTS	08/18/2025	\$216.24	P
16252016	CROCKETT SEPTIC LLC	PORTABLE TOILET PUMPING FEE	08/07/2025	\$80.00	P
16252017	CROCKETT SEPTIC LLC	PORTABLE TOILET PUMPING FEE	09/04/2025	\$80.00	P
16252018	FASTENAL COMPANY	PARTS	08/13/2025	\$76.89	P
16252019	FASTENAL COMPANY	PARTS	08/20/2025	\$240.81	P
16252020	FASTENAL COMPANY	PARTS	08/27/2025	\$338.42	P
16252021	FLEETPRIDE	PARTS	08/26/2025	\$2,127.88	P
16252022	FARRELL EQUIPMENT & SUPPLY CO	PARTS	08/20/2025	\$279.98	P
16252023	FARRELL EQUIPMENT & SUPPLY CO	PARTS	08/26/2025	\$1,199.92	P
16252024	FORCE AMERICA INC	PARTS	08/11/2025	\$302.36	P
16252025	FORCE AMERICA INC	PARTS	08/25/2025	\$2,064.98	P
16252026	1ST AYD CORPORATION	SHOP SUPPLIES	08/28/2025	\$362.44	P
16252027	FRONTIER	TELEPHONE - MFLD	08/28/2025	\$95.02	P
16252028	GRAY'S INC	PLOW BLADES	08/21/2025	\$13,065.00	P
16252029	GENERAL FARM SUPPLY INC	SEED	07/28/2025	\$610.00	P

HIGHWAY - AUGUST

16251909 - 16252177

Voucher	Vendor Name	Nature of Claim	Doc Date	Amount	Paid
16252030	HALRON LUBRICANTS INC	PARTS	08/07/2025	\$99.76	P
16252031	HALRON LUBRICANTS INC	PARTS	08/28/2025	\$711.84	P
16252032	HALRON LUBRICANTS INC	PARTS	08/28/2025	\$1,194.00	P
16252033	INSIGHT FS	LP GAS	08/12/2025	\$23.22	P
16252034	ISTATE TRUCK CENTER	PARTS	08/04/2025	\$235.51	P
16252035	ISTATE TRUCK CENTER	PARTS	08/04/2025	\$224.79	P
16252036	ISTATE TRUCK CENTER	PARTS	08/06/2025	\$131.26	P
16252037	ISTATE TRUCK CENTER	PARTS	08/06/2025	(\$43.00)	P
16252038	ISTATE TRUCK CENTER	PARTS	08/07/2025	(\$31.05)	P
16252039	ISTATE TRUCK CENTER	PARTS	08/13/2025	\$310.83	P
16252040	ISTATE TRUCK CENTER	PARTS	08/14/2025	\$31.36	P
16252041	ISTATE TRUCK CENTER	PARTS	08/14/2025	\$2.16	P
16252042	ISTATE TRUCK CENTER	PARTS	08/18/2025	\$419.27	P
16252043	ISTATE TRUCK CENTER	PARTS	08/21/2025	\$305.98	P
16252044	ISTATE TRUCK CENTER	PARTS	08/26/2025	\$1,665.35	P
16252045	ISTATE TRUCK CENTER	PARTS	08/27/2025	\$93.83	P
16252046	ISTATE TRUCK CENTER	PARTS	08/29/2025	\$93.83	P
16252047	ISTATE TRUCK CENTER	PARTS	08/27/2025	\$231.64	P
16252048	JACO TRUCKING LLC	PRIVATE TRUCKS	08/31/2025	\$960.00	P
16252049	JAGS FABRICATION INC	T/MFLD DAY ROAD	08/28/2025	\$8,330.00	P
16252050	JAGS FABRICATION INC	T/MFLD DAY ROAD	09/04/2025	\$270.00	P
16252051	JEFF ERTL TRUCKING LLC	PRIVATE TRUCKS	08/31/2025	\$960.00	P
16252052	JFTCO INC	SKID STEER RENTAL	08/22/2025	\$3,226.50	P
16252053	JFTCO INC	SKID STEER RENTAL	08/19/2025	\$47.46	P
16252054	JFTCO INC	SKID STEER RENTAL	08/20/2025	\$158.20	P
16252055	JFTCO INC	EXCAVATOR RENTAL	08/26/2025	\$13,400.00	P
16252056	JFTCO INC	PARTS	08/14/2025	\$11.05	P
16252057	JFTCO INC	PARTS	08/26/2025	\$461.13	P
16252058	JFTCO INC	PARTS	08/28/2025	\$14.95	P
16252059	JFTCO INC	PARTS	08/29/2025	\$313.12	P
16252060	KRIETE TRUCK CENTER	PARTS	08/12/2025	\$40.00	P
16252061	KRIETE TRUCK CENTER	PARTS	08/26/2025	\$572.78	P
16252062	MANITOWOC COUNTY HIGHWAY DEPT	POLYJACKING	08/15/2025	\$1,268.97	P
16252063	MARSHFIELD UTILITIES	UTILITIES - MFLD	08/29/2025	\$146.89	P
16252064	MARSHFIELD UTILITIES	UTILITIES - MFLD	08/29/2025	\$585.74	P
16252065	MARSHFIELD UTILITIES	UTILITIES - MFLD	08/29/2025	\$48.58	P
16252066	MILESTONE MATERIALS	AGGREGATES	08/27/2025	\$3,028.50	P
16252067	MILESTONE MATERIALS	AGGREGATE MATERIALS	08/27/2025	\$5,256.89	P
16252068	MILESTONE MATERIALS	AGGREGATES	08/29/2025	\$202.58	P
16252069	MILESTONE MATERIALS	AGGREGATES	08/29/2025	\$399.49	P
16252070	MILESTONE MATERIALS	AGGREGATES	08/29/2025	\$1,240.56	P
16252071	MILESTONE MATERIALS	PARTS	08/29/2025	\$2,809.50	P
16252072	MILESTONE MATERIALS	AGGREGATES	09/05/2025	\$3,111.39	P
16252073	MILESTONE MATERIALS	AGGREGATES	09/05/2025	\$624.16	P

HIGHWAY - AUGUST

16251909 - 16252177

Voucher	Vendor Name	Nature of Claim	Doc Date	Amount	Paid
16252074	MILESTONE MATERIALS	AGGREGATES	09/05/2025	\$7,663.76	P
16252075	MILESTONE MATERIALS	AGGREGATES	09/08/2025	\$8,080.52	P
16252076	MILLER-BRADFORD & RISBERG INC	PARTS	08/11/2025	\$328.74	P
16252077	MISSISSIPPI WELDERS SUPPLY CO INC	WELDING SUPPLIES	08/14/2025	\$79.43	P
16252078	MISSISSIPPI WELDERS SUPPLY CO INC	WELDING SUPPLIES	08/28/2025	\$70.65	P
16252079	MISSISSIPPI WELDERS SUPPLY CO INC	WELDING SUPPLIES	08/31/2025	\$294.50	P
16252080	MONROE TRUCK EQUIPMENT	PARTS	08/15/2025	\$1,284.90	P
16252081	MONROE TRUCK EQUIPMENT	PARTS	08/18/2025	\$147.98	P
16252082	MOSINEE MACHINE & ELECTRIC	PARTS	08/06/2025	\$185.00	P
16252083	MOTORS AND CONTROLS LLC	PARTS	08/28/2025	\$396.56	P
16252084	NAPA CENTRAL WI AUTO PARTS	PARTS	08/21/2025	\$301.56	P
16252085	NAPA CENTRAL WI AUTO PARTS	PARTS	08/19/2025	\$551.70	P
16252086	NAPA CENTRAL WI AUTO PARTS	PARTS	08/27/2025	\$56.16	P
16252087	NAPA CENTRAL WI AUTO PARTS	PARTS	08/27/2025	\$142.99	P
16252088	NAPA CENTRAL WI AUTO PARTS	PARTS	08/21/2025	\$308.99	P
16252089	NOVUS AUTO GLASS	GLASS REPAIR	08/18/2025	\$375.00	P
16252090	PRECISE MRM LLC	FLAT PLAN USA GPRS	09/01/2025	\$550.00	P
16252091	RAPIDS FORD LLC	PARTS	09/04/2025	\$599.67	P
16252092	RAPIDS RENTAL & SUPPLY	PARTS	08/19/2025	\$38.99	P
16252093	SCHIFERL RADIATOR & WELDING	PARTS	08/04/2025	\$1,692.71	P
16252094	SCHILL TRUCKING INC	PRIVATE TRUCKS	08/31/2025	\$6,360.00	P
16252095	SCHILLING SUPPLY COMPANY	SHOP SUPPLIES	08/12/2025	\$260.04	P
16252096	SHERWIN WILLIAMS	PAINT	08/07/2025	\$177.15	P
16252097	S&R TRUCK LLC	3138 PATROL TRUCK	08/07/2025	\$125,800.00	P
16252098	STERLING WATER INC	WATER FOR HOT MIX	09/01/2025	\$14.55	P
16252099	SWIDERSKI EQUIPMENT INC	PARTS	08/05/2025	\$258.62	P
16252100	SUPERIOR CHEMICAL LLC	SHOP SUPPLIES	08/20/2025	\$112.87	P
16252101	TRACTOR SUPPLY CREDIT PLAN	PARTS	08/31/2025	\$645.94	P
16252102	TRI-COUNTY PAVING INC	MILLING AND PULVERIZING	08/28/2025	\$36,326.48	P
16252103	TRUCK COUNTRY OF WISCONSIN	PARTS	04/09/2025	\$89.78	P
16252104	TRUCK COUNTRY OF WISCONSIN	PARTS	08/14/2025	\$240.00	P
16252105	TRUCK COUNTRY OF WISCONSIN	PARTS	08/14/2025	(\$240.00)	P
16252106	TRUCK COUNTRY OF WISCONSIN	PARTS	08/14/2025	\$240.00	P
16252107	TRUCK COUNTRY OF WISCONSIN	PARTS	08/20/2025	\$194.80	P
16252108	TRUCK COUNTRY OF WISCONSIN	PARTS	08/20/2025	\$54.80	P
16252109	TRUCK COUNTRY OF WISCONSIN	PARTS	08/21/2025	\$77.80	P
16252110	TRUCK COUNTRY OF WISCONSIN	PARTS	08/26/2025	(\$510.00)	P
16252111	V & H AUTOMOTIVE INC	PARTS	08/12/2025	\$261.25	P
16252112	WASTE MANAGEMENT	GARBAGE DISPOSAL	09/04/2025	\$254.68	P
16252113	WATER WORKS & LIGHTING COMM	UTILITIES - WR SHOP	08/27/2025	\$33.17	P
16252114	WATER WORKS & LIGHTING COMM	UTILITIES - WR SHOP	08/27/2025	\$2,785.82	P
16252115	WATER WORKS & LIGHTING COMM	UTILITIES - WR SHOP	08/27/2025	\$14.70	P
16252116	WATER WORKS & LIGHTING COMM	UTILITIES - WR SHOP	08/27/2025	\$2.48	P
16252117	WATER WORKS & LIGHTING COMM	UTILITIES - WR SHOP	08/27/2025	\$2.48	P

HIGHWAY - AUGUST

16251909 - 16252177

Voucher	Vendor Name	Nature of Claim	Doc Date	Amount	Paid
16252118	WATER WORKS & LIGHTING COMM	UTILITIES - HOT MIX	08/27/2025	\$5,427.78	P
16252119	WATER WORKS & LIGHTING COMM	UTILITIES - BRINE	08/27/2025	\$297.13	P
16252120	WE ENERGIES	NATURAL GAS - HOT MIX	09/03/2025	\$2,892.51	P
16252121	WE ENERGIES	NATURAL GAS - BRINE	09/04/2025	\$9.24	P
16252122	WE ENERGIES	NATURAL GAS - WR SHOP	09/04/2025	\$67.49	P
16252123	WE ENERGIES	NATURAL GAS - WR SHOP	09/04/2025	\$15.69	P
16252124	WEICHELTRUCKING & EXCAVATING	PRIVATE TRUCKS	08/31/2025	\$3,327.50	P
16252125	WEYERS EQUIPMENT INC	PARTS	08/07/2025	\$231.00	P
16252126	WHIRLWIND SWEEPING WI INC	MILLING	09/01/2025	\$3,800.00	P
16252127	WISCO DBE LLC	OIL FOR HOT MIX	09/03/2025	\$12,048.10	P
16252128	WISCO DBE LLC	OIL FOR HOT MIX	09/08/2025	\$12,113.20	P
16252129	WISCONSIN METALS	BLACKSMITH STEEL	08/04/2025	\$177.00	P
16252130	WISCONSIN METALS	BLACKSMITH STEEL	08/18/2025	\$1,010.00	P
16252131	WISCONSIN METALS	BLACKSMITH STEEL	08/18/2025	\$198.00	P
16252132	WI DEPT OF TRANSPORTATION - BFS	PROJECT COSTS	09/02/2025	\$1,835.37	P
16252133	WISCONSIN LIFTING SPECIALISTS	PARTS	08/07/2025	\$1,050.71	P
16252134	WISCONSIN VALLEY BUILDING PRODUCTS	PARTS	08/12/2025	\$86.80	P
16252135	WISCONSIN VALLEY BUILDING PRODUCTS	PARTS	08/19/2025	\$318.00	P
16252136	AMAZON CAPITAL SERVICES	PARTS	09/11/2025	\$243.70	
16252137	AMAZON CAPITAL SERVICES	PARTS	09/11/2025	\$44.29	
16252138	AMAZON CAPITAL SERVICES	PARTS	09/10/2025	\$84.99	
16252139	AMAZON CAPITAL SERVICES	PARTS	09/10/2025	\$11.99	
16252140	AMAZON CAPITAL SERVICES	PARTS	09/12/2025	\$69.00	
16252141	ADAMS COUNTY HIGHWAY DEPT	PAINTING	08/31/2025	\$99,881.52	
16252142	AL-CHROMA	ASPHALT TACK	08/05/2025	\$267.00	
16252143	BECKER TRUCKING & EXCAVATING INC	AGGREGATES	09/02/2025	\$273.22	
16252144	BOHN TRUCKING & EXCAVATING INC	HOT MIX SAND	09/10/2025	\$9,019.36	
16252145	CINTAS CORPORATION	CLEANING RUGS & UNIFORMS	08/04/2025	\$529.73	
16252146	CINTAS CORPORATION	CLEANING RUGS & UNIFORMS	08/11/2025	\$529.73	
16252147	CINTAS CORPORATION	CLEANING RUGS & UNIFORMS	08/18/2025	\$529.73	
16252148	CINTAS CORPORATION	CLEANING RUGS & UNIFORMS	08/25/2025	\$529.73	
16252149	CINTAS CORPORATION	CLEANING RUGS & UNIFORMS	08/06/2025	\$1,231.08	
16252150	CINTAS CORPORATION	CLEANING RUGS & UNIFORMS	08/13/2025	\$1,230.67	
16252151	CINTAS CORPORATION	CLEANING RUGS & UNIFORMS	08/20/2025	\$1,230.67	
16252152	CINTAS CORPORATION	CLEANING RUGS & UNIFORMS	08/27/2025	\$1,274.33	
16252153	CINTAS CORPORATION	CLEANING RUGS & UNIFORMS	08/06/2025	\$49.92	
16252154	CINTAS CORPORATION	CLEANING RUGS & UNIFORMS	08/20/2025	\$49.92	
16252155	CNE GAS	NATURAL GAS - HOT MIX	09/10/2025	\$6,967.34	
16252156	ECON ELECTRIC	CRANE REPAIR	09/11/2025	\$250.00	
16252157	FOEMMEL JAMIE	RETURN OF PERMIT DEPOSIT	09/09/2025	\$300.00	
16252158	HIGHWAY CONSTRUCTION PRODUCTS LLC	CTH U STRUCTURES	09/02/2025	\$296.60	
16252159	HOME DEPOT CREDIT SERVICES	PARTS	09/05/2025	\$177.98	
16252160	LEICA GEOSYSTEMS INC	CS20 BASIC CCP	09/11/2025	\$657.00	
16252161	MILESTONE MATERIALS	AGGREGATES	08/31/2025	\$3,168.04	

HIGHWAY - AUGUST

16251909 - 16252177

Voucher	Vendor Name	Nature of Claim	Doc Date	Amount	Paid
16252162	MILESTONE MATERIALS	AGGREGATES	09/10/2025	\$204.24	
16252163	MILESTONE MATERIALS	AGGREGATES	09/10/2025	\$7,414.55	
16252164	MILESTONE MATERIALS	AGGREGATES	09/15/2025	\$404.01	
16252165	PROVISION PARTNERS	DIESEL FUEL AND GASOLINE	08/31/2025	\$33,217.69	
16252166	ROGANS SHOES	SAFETY SHOES	09/16/2025	\$100.00	
16252167	SICALCO LTD	CALCIUM CHLORIDE	09/05/2025	\$3,776.27	
16252168	VARITECH INDUSTRIES INC	9081/9082/9083 BRINE TANKS	09/09/2025	\$38,223.00	
16252169	WATER WORKS & LIGHTING COMM	UTILITIES - HOT MIX	09/10/2025	\$277.99	
16252170	WE ENERGIES	NATURAL GAS - MFLD SHOP	09/11/2025	\$58.41	
16252171	WESTWOOD PROFESSIONAL SERVICES INC	CTH U EXTENSION	09/08/2025	\$11,792.17	
16252172	WISCO CONCRETE SOLUTIONS	CTH U	09/12/2025	\$72,860.86	
16252173	US BANK	P-CARD PURCHASES	09/17/2025	\$1,593.07	
16252174	WISCO DBE LLC	OIL FOR HOT MIX	09/21/2025	\$11,876.04	
16252175	WISCO DBE LLC	OIL FOR HOT MIX	09/19/2025	\$11,745.85	
16252176	WISCO DBE LLC	OIL FOR HOT MIX	09/15/2025	\$12,341.04	
16252177	CITY OF WIS RAPIDS TREASURER	SCREENED BLACK DIRT	08/26/2025	\$153.20	
Grand Total:				\$882,000.01	

Signatures

Committee Chair:

Committee Member:

Committee Member:

Committee Member:

Committee Member:

Committee Member:

Committee Member:

Committee Member:

Committee Member:



RESOLUTION#

DATE October 21, 2025

Effective Upon passage and
Date publication

Page 1 of 2

Introduced by Highway Infrastructure and Recreation Committee

Motion:	Adopted:	<input type="checkbox"/>
1 st	Lost:	<input type="checkbox"/>
2 nd	Tabled:	<input type="checkbox"/>
No: _____	Yes: _____	Absent: _____
Number of votes required:		
<input checked="" type="checkbox"/> Majority <input type="checkbox"/> Two-thirds		
Reviewed by: _____, Corp Counsel		
Reviewed by: _____, Finance Dir.		

INTENT & SYNOPSIS: To amend Access Ordinance #401, Highway Access Control Ordinance to include building setback lines.

FISCAL NOTE: None

WHEREAS, the current Access Ordinance #401 does not include building setback lines.

WHEREAS, the current Zoning Ordinance No. 701 Land Subdivision covers building setback lines on newly divided land.

WHEREAS, building set back limits are needed to ensure that buildings do not encroach on the highway right-of-way to maintain safety for the traveling public, provide space for essential utilities, provide space for vehicles stored on driveways, and provide space to maintain drainage and snow storage.

NOW THEREFORE BE IT ORDAINED, that the Wood County Board of Supervisors hereby adopts the proposed amendments to Wood County Highway Access Control Ordinance #401, adding Chapter 401-6 Setback Lines.

Chapter 401-6 Setback Lines

6.1 Building Setback Lines

Building setback lines shall conform to the requirements of the applicable zoning ordinance or the following, whichever is more restrictive.

- A. Federal and State Highways. One hundred-ten (110) feet from the center line of the highway or fifty (50) feet from the right-of-way line, whichever is greater.

Adopted by the County Board of Wood County, October 21, 2025

County Clerk

County Board Chairman

- B. County Highways. Seventy-five (75) feet from the centerline of such highway or forty-two (42) feet from the right-of-way line, whichever is greater.
- C. Town Roads. Sixty-three (63) feet from the centerline of such highway or thirty (30) feet from the right-of-way line, whichever is greater.
- D. Visual Clearance Triangle.
 - 1. In each quadrant of every public street intersection there shall be a visual clearance triangle per Zoning Ordinance 701-34.
 - a. At intersections with speeds of thirty-five (35) miles per hour or greater in both directions of travel, the visual clearance triangle shall be determined by measuring sixty (60) feet along the property line for any "uncontrolled" traffic (not regulated by stop sign) and thirty (30) feet along the property line for any "controlled" traffic (regulated by stop sign).
 - b. At intersections with speeds of less than thirty-five (35) miles per hour in either direction of travel the visual clearance triangle shall extend fifteen (15) feet along the lot line in all directions of travel.
 - 2. Objects permitted within highway setback lines and visual clearance triangles:
 - a. Open fences.
 - b. Utility poles and lines, and portable equipment.
 - c. The planting and harvesting of field crops, shrubbery and trees except that no trees or shrubbery shall be planted within a visual clearance triangle so as to obstruct the view.
 - d. Corner lots shall meet building setbacks from both streets.
- E. Penalties
 - 1. Failure to comply with setback limits can result in a penalty of not less than \$50 and not more than \$500 pursuant to and in accordance with Wisconsin Statute ss. 66.0113 and 86.07(2)(a).

BE IT FURTHER ORDAINED, that the Wood County Highway Ordinance #401 as amended by this action become effective upon passage and publication as required by statute.



Parks & Forestry Department Reports

October 2, 2025

Director Report, by Chad Schooley

- Powers Bluff Trailhead Shelter project has started. Footings have been poured and frost walls will be poured by 9/26/25.
- Continue design work for Dexter Beach House construction project. I received correspondence from WIDNR that we will be awarded the \$300,000 Stewardship grant that I submitted this year for this project. This amount will be added to the \$300,000 ARPA funds that have been approved for this project.
- Continue planning for other ARPA projects: South Park shower building, playground equipment replacement, Powers Bluff old shop site, etc..
- Continue assisting with update of Parks, Recreation, and Open Spaces plan. A draft copy will be sent to members prior to the meeting to review. Fred Heider will be at meeting to address any questions/concerns.
- Following the meeting we will have the annual Parks, Forestry, and Hwy Tour. A tour schedule is included in the packet. Tour stops are all weather and time dependent. We will be back to the WR Hwy Shop no later than 3:00 pm.
- **Special Use Permits**
 - None at this time

Maintenance Program Supervisor Report, by Dan Vollert

Construction Projects

- South Park-cap north fireplace chimney on Red Beach Stone Shelter.
- South Park-Campground Storage Shed is ordered and site is prepped.
- CERA Park-Reroofing small pumphouse and old scoreboard buildings.
- Dexter Park: Old beachhouse ready for demolition by Highway and designs for new shelter being determined.
- Dexter Park: Shelter had new concrete approach put in on all four sides and side walk to Hwy. 80 boat landing put in. Parking lot was resurfaced.
- North Park: Looking at replacing hand railing on Suspension Bridge.
- Powers Bluff: New Trailhead Shelter started with frostwalls poured. Gates installed for trailhead entrance road & new shop.

Maintenance Operations

- ALL Parks: Closed beaches after Labor Day Weekend.
- Dexter Park: Landscaping around new side walk and parking lot at shelter area.
- South Park: Continue storm cleanup, from June 23 storm, that took down many trees throughout park.
- Powers Bluff: Painting gates, staining tongue & groove planking for new Trail Head Building.

- Powers Bluff: New Shop setup. New work benches, air compressor with hose adapters, racking, etc. Old Shop ready for demolition by Highway.
- CERA Park: Doors rekeyed in all buildings to common keys.
- CERA Park: Following park closing September 30- Winterizing park: docks pulled, buildings shutdown, water lines blown out, clean out shop buildings.

Employee Matters

- Benefit open enrollment meeting slated for Oct. 8 at Highway Dept.
- LTE's finishing up for the summer. All will be done by the end of September.
- Looking at updating three FTE's from Class B CDL to a Class A through Highway Department CDL training program.

Snowmobile/ATV

- Auburndale (DH) Snowmobile Bridge project off of CTH N east of Arpin is being done by Earth Inc. Abutments are installed, rip-rapped, and bridge is set. Project approaches will be completed once things dry up in area and frost firms things up.
- 2024-2025 ATV Trail Maintenance Grant Reimbursement Request was sent in and awaiting payment.
- 2024-2025 ATV Intensive Use Area Grant Reimbursement Request was sent in and awaiting payment.
- Range Road ATV Connector Trail to Intensive Use Area is being stripped of stumps and shaped up by Highway Dept. Hoping to install road base this fall/winter.
- Hay Creek-Peterson Road ATV Trail will be closed for season on October 26, along with Jackson County Trails, for deer & snowmobile seasons.

Office Supervisor Report, by Stacie Kleifgen

- Reconciled 2025 Accounts Receivable Year to Date and updated documentation process.
- Worked with Corp. Counsel to update proper documentation and process for unpaid violations. Forwarded unpaid violations to Sheriff's Department.
- Reconciled Non-Lapsing and ARPA Accounts

Forest Administrator Report, by Fritz Schubert

- Timber Sales: Two active timber sales in September. Although some mills have curtailed deliveries due to maintenance and repairs, logging activity may increase in the next couple months once their maintenance is completed and wood consumption increases (weather permitting).
- Worked with Nick Flanagan Corp. Counsel on Accessible Hunting Blind Policy and land trade proposal discussed at September HIRC. Materials for both are included in HIRC packet.
- Timber sale establishment in compartment 37.
- Worked with snowmobile coordinator on trail reroute in Wood County Forest.
- Forestry Technician: Cleaned and mowed shooting range. Painted forestry gates. Skid steer maintenance and repairs. Mowed county forest roads and trails. Improved /graded Hazelnut Trail including delivery of 15 loads of road base. Began work on snowmobile trail reroute.

ACCESSIBLE HUNTING BLIND RULES AND RESERVATION POLICY

- **Location:** Wood County has two Accessible Hunting Blinds which may be reserved by filling out an application. The hunting blind locations are both west of the intersection of CTH G and STH 54 and are depicted on a map accompanying the application. Applications must designate which blind they wish to reserve.
- **Reservation and Rules:** Hunters wishing to reserve a blind must complete an Accessible Hunting Blind Application. Reservations may be made on-line, by phone, or in the Parks and Forestry office at 111 W. Jackson Street, Wisconsin Rapids 8am-4pm M-F. The following rules shall apply to hunting blind reservations:
 - Hunters wishing to reserve a blind are required to possess a Wisconsin DNR Class A, B, C, or D Hunting Disability Permit.
 - Blinds are reservable for dates coinciding with any Wisconsin Deer or Turkey season. Blinds are not reservable for any other timeframe.
 - The reservation fee is \$20.00/day and **is not refundable.** Payment can be made with cash, check, or credit card.
 - Reservations are on a first come first served basis and can be made for up to two consecutive days maximum. The same individual may not make back-to-back reservations. Reservations by the same individual shall be separated by a minimum of two days.
 - Reservations are based on a 24-hour clock, start at 00:00 and end at 24:00. Blinds may be occupied at any time within the reservation period.
 - Blinds may be reserved up to one year in advance. Consecutive days may be reserved up to one year in advance of the initial day.
- **Cancellation Policy:** There will be no refunds for cancellations. However, hunters who find themselves unable to keep their reservations are encouraged to cancel in consideration of others who may want to use the blind(s). Cancellations may be accomplished on-line, by phone, or in the Parks and Forestry office at 111 W. Jackson Street, Wisconsin Rapids 8am-4pm M-F.
- **Capacity and Guest Limitations:** Reservations allow one hunter and up to two hunter's assistants maximum. The hunter is the only person allowed to utilize a firearm, bow, or crossbow in the blind.
- **Hunting Area:** Permitted hunter must hunt from the established blind or immediately adjacent to it.
- **Animals:** All animals are prohibited in the blind except service animals that are reasonably necessary for the applicant. Service animals shall be under the immediate control of the person in need of service at all times. Animals are allowed outdoors if they are under the immediate control of an adult by a leash that shall not exceed six feet in length at full extension.
- **Responsibilities:** Permitted hunter is responsible for possessing appropriate licenses and permits, knowing and understanding all appropriate hunting regulations and hunting during appropriate dates and times.
- **County Forest Use:** The hunting area is part of the Wood County Forest. The public does have the right to use all areas of the County Forest, but they do not have the right to intentionally disrupt the hunting experience.

- **Parking:** Only one vehicle is allowed within designated hunting areas (i.e. behind gates). Parking is available in the public parking area outside gates but must not block route through gates. Personal mobility devices used as a transport aid do not require a permit for use within designated hunting areas by those who have reserved a blind.
- **Access to Blind:** Access of the blind will be locked with a combination lock. The combination to open it will be given at the time of reservation. Access Gates are to be closed and locked when blinds are unoccupied.
- **Revocation and/or Removal:** The County, in its discretion, may revoke any rental agreement for any violation of the Agreement, order the Lessee and all guests/invitees to leave the accessible blind area immediately, and seek law enforcement assistance for noncompliance.
- **Alcohol:** Individuals may not consume any form of alcohol when using the hunting blind or engaged in any other activities associated with the hunting blind. Violation of this provision will result in revocation of a permit and being asked to leave the blind and/or hunting area and may result in a bar from use of the hunting blind and denial of future applications for its use.
- **Blind Care and Damages:** Individuals are responsible for any cleanup and welfare of the blinds and surrounding area. Additionally, users are required report any damage to the facilities by said users. Users are also encouraged to report any damage or inadequacies noted upon entry to the blind/facility.

Wood County Forest Handicap Hunting Blinds Location Map

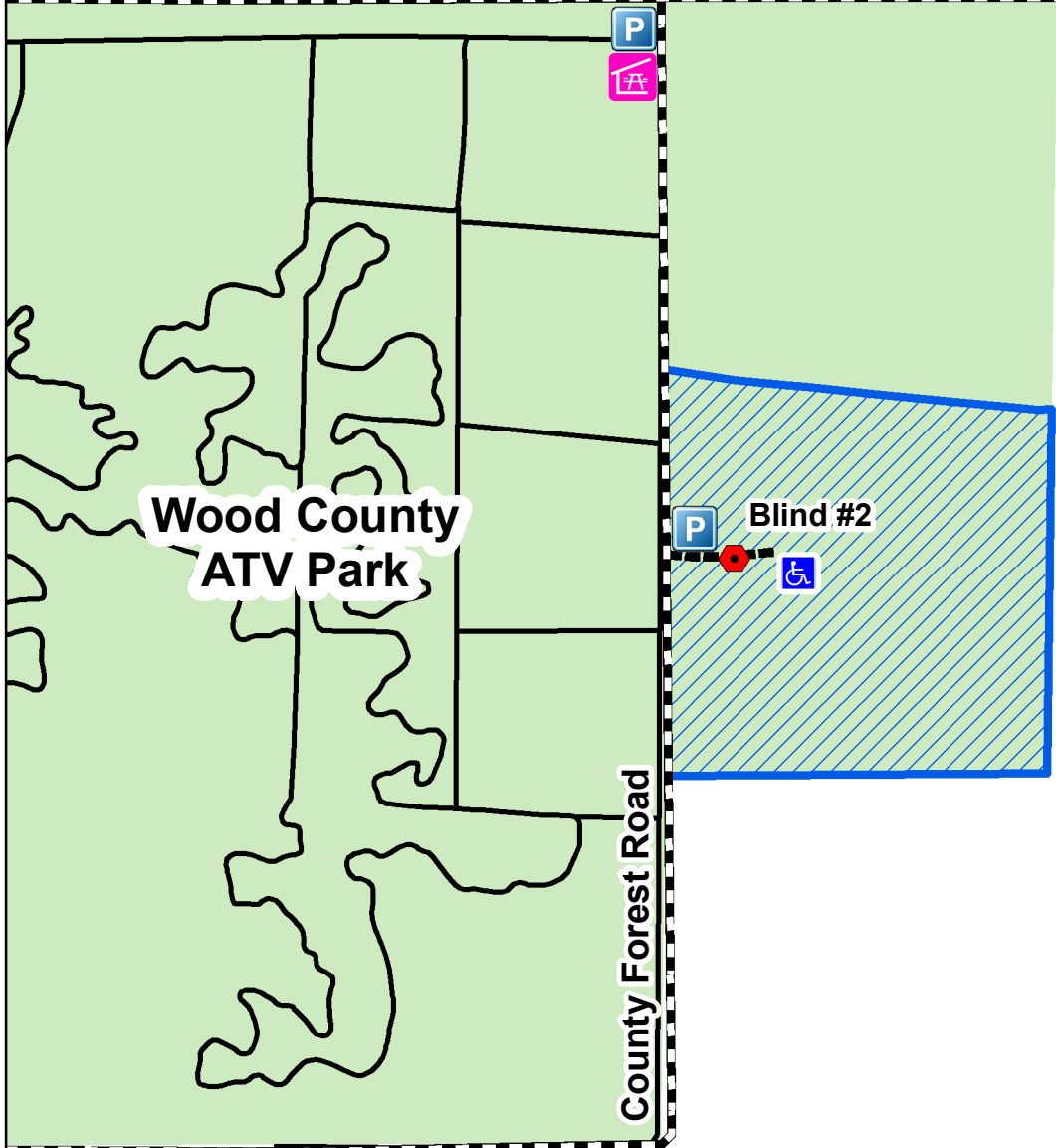
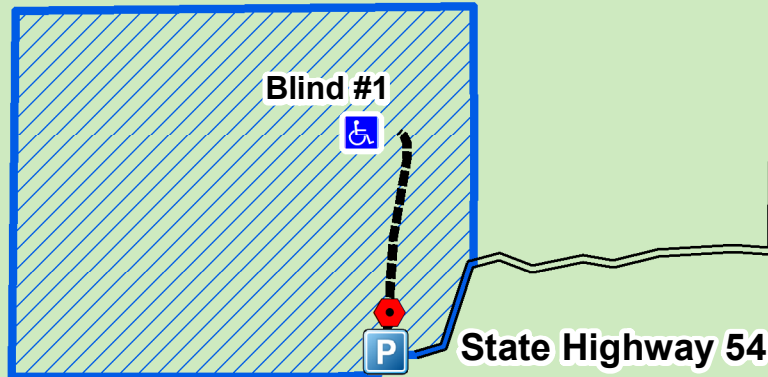

Legend

- Roads
- ATV Trails
- Handicap Blind Access Roads
- WCF Access Roads
- Handicap Hunting Blinds
- Gates
- Parking Area
- ATV Park Shelter Building
- Handicap Hunting Areas
- Wood County Forest Property

Scale 8in=1Mile

Wood County Forest Handicap Hunting Blinds Location Map



**Wood County
ATV Park**

County Forest Road

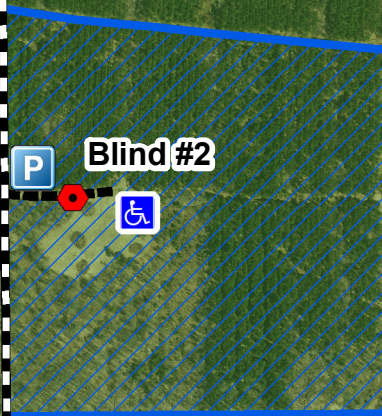

Legend

- Roads
- ATV Trails
- Handicap Blind Access Roads
- WCF Access Roads
- Handicap Hunting Blinds
- Gates
- Parking Area
- ATV Park Shelter Building
- Handicap Hunting Areas
- Wood County Forest Property

Scale 8in=1Mile

CAUTION



**ACCESSIBLE
HUNTING AREA**



RESOLUTION#

DATE October 21, 2025

Effective
Date

October 21, 2025

Page 1 of 2

Introduced by Highway Infrastructure & Recreation Committee

Motion:	Adopted:	<input type="checkbox"/>
1 st	Lost:	<input type="checkbox"/>
2 nd	Tabled:	<input type="checkbox"/>
No: _____	Yes: _____	Absent: _____
Number of votes required:		
<input type="checkbox"/> Majority	<input checked="" type="checkbox"/> Two-thirds	
Reviewed by: _____	NF	, Corp Counsel
Reviewed by: _____	PY	, Finance Dir.

INTENT & SYNOPSIS: To acquire land for addition to the Wood County Forest in exchange for land currently enrolled in the County Forest Program, and to seek Wisconsin Department of Natural Resources approval of the proposed addition and withdrawal of Wood County Forest Land.

FISCAL NOTE: In addition to the land exchange, Wood County will pay the trading partner \$9,100.00 based on the appraised land value. Wood County will be responsible for paying associated closing and recording fees.

		NO	YES	A
1	Schulz, W			
2	Rozar, D			
3	Buttke, T			
4	Perlock, R			
5	Hovendick, T			
6	Breu, A			
7	Voight, W			
8	Hahn, J			
9	Brehm, S			
10	Thao, L			
11	Penzkover, J			
12	Valenstein, L			
13	Hokamp, J			
14	Polach, D			
15	Clendenning, B			
16	Pliml, L			
17	Zurfluh, J			
18	Hamilton, B			
19	Leichtnam, B			

WHEREAS, Nekoosa Marsh Road Cranberry LLC (NMRC) has operations adjacent to the Wood County Forest; and

WHEREAS, NMRC has proposed a land trade with Wood County in which they would acquire 20 acres of Wood County Forest Land located in the Town of Seneca, in exchange for 46.95 acres of land which they own in the Town of Dexter; and

WHEREAS, NMRC has proposed a 2:1 ratio of value in favor of Wood County based on qualified land appraisals; and

WHEREAS, NMRC has ordered and paid for said land appraisals which value the 20-acre Wood County parcel at \$60,000 and the 46.95-acre parcel at \$129,100; and

WHEREAS, sufficient funds exist in the non-lapsing County Forest Land Fund account 243-2100-34112-000-000 in order pay \$9,100.00 to achieve the 2:1 ratio previously stated; and

WHEREAS, removal and enrollment of said lands are subject to WDNR approval as established in Wisconsin Statute 28.11; and

Adopted by the County Board of Wood County, October 21, 2025

County Clerk

County Board Chairman

WHEREAS, the Wood County Highway Infrastructure and Recreation Committee has studied this land trade proposal and considered the recommendation of Wood County Forest Administrator and believes it to be in the County's best interest to pursue.

NOW THEREFORE BE IT RESOLVED, the Wood County Board of Supervisors accepts the recommendation of the Wood County Forest Administrator and the Wood County Highway Infrastructure and Recreation Committee and hereby approves the ownership exchange as proposed herein, contingent upon approval of the Wisconsin Department of Natural Resources approving the removal and enrollment of said property in the County Forest Law program. To effectuate the trade, the Board of Supervisors:

- A. Authorize and direct the Wood County Forest Administrator to submit applications to WDNR for withdrawal of the 20-acre parcel from, and entry of the 46.95-acre parcel into the County Forest program.
- B. Authorize and direct the Wood County Clerk and County Board Chairperson to execute all legal documents necessary to complete the transaction mentioned above and enroll the newly acquired property into County Forest Law pursuant to Chapter 28.11(4) of the Wisconsin Statutes.
- C. Direct \$9,100 to be paid as expenses from the County Forest Land Fund (account# 243-2105-56912-000-340)

**WOOD COUNTY, PARKS & FORESTRY - FOREST ADMINISTRATOR
REVENUE REPORT & TIMBER SALE BALANCES**

September 2025 Revenue (October HIRC)

Budget Year 2025

CONTRACT	TRACT	CONTRACTOR	CONTRACT AWARD AMOUNT	CONTRACT AWARD DATE	CONTRACT EXPIRATION DATE	\$ RECEIVED CURRENT MONTH	AMOUNT BILLED TO DATE	AMOUNT RCVD TO DATE	BALANCE
780	2-16	MIDWEST HW	\$42,886.00	7/10/2020	7/31/2026		\$31,778.92	\$31,778.92	\$0.00
790	4-21	SCHREINER	\$15,600.00	11/24/2021	12/31/2025		\$0.00	\$0.00	\$0.00
797	3-22	SCHREINER	\$30,770.00	5/27/2022	6/30/2026		\$0.00	\$0.00	\$0.00
800	6-22	SCHREINER	\$16,440.00	5/27/2022	7/31/2026		\$0.00	\$0.00	\$0.00
801	7-22	WILSON	\$11,750.00	8/4/2022	7/31/2026		\$0.00	\$0.00	\$0.00
803	9-22	KOERNER	\$21,057.80	11/16/2022	12/31/2025		\$0.00	\$0.00	\$0.00
804	10-22	KOERNER	\$84,093.60	11/16/2022	12/3/2025		\$103,155.10	\$103,155.10	\$0.00
807	13-22	FLINK	\$9,450.00	12/31/2022	12/31/2025		\$2,274.03	\$2,274.03	\$0.00
812	4-23	FLINK	\$11,813.85	6/1/2023	6/30/2026		\$7,418.12	\$7,418.12	\$0.00
814	6-23	FLINK	\$21,055.00	4/28/2025	3/31/2028		\$0.00	\$0.00	\$0.00
816	8-23	KOERNER	\$31,625.00	1/4/2024	12/31/2025		\$0.00	\$0.00	\$0.00
817	9-23	KOERNER	\$17,310.00	1/4/2024	12/31/2025		\$0.00	\$0.00	\$0.00
818	10-23	MIDWEST HW	\$51,768.30	1/4/2024	12/31/2026		\$0.00	\$0.00	\$0.00
819	11-23	TNT Timber	\$124,257.30	4/30/2024	5/1/2026		\$0.00	\$0.00	\$0.00
821	1-24	KOERNER	\$26,270.00	4/30/2024	5/1/2026		\$0.00	\$0.00	\$0.00
824	5-24	KOERNER	\$53,280.00	4/30/2024	5/1/2026		\$0.00	\$0.00	\$0.00
826	6-24	BIEWER	\$158,818.20	12/19/2024	12/31/2026		\$0.00	\$0.00	\$0.00
827	7-24	MEDDA	\$60,286.80	12/19/2024	12/31/2026		\$0.00	\$0.00	\$0.00
828	8-24	MIDWEST HW	\$75,328.40	12/19/2024	12/31/2026		\$0.00	\$0.00	\$0.00
832	2-25	KOERNER	\$19,840.00	6/18/2025	6/30/2027		\$0.00	\$0.00	\$0.00
833	3-25	KOERNER	\$7,740.00	6/18/2025	6/30/2027		\$0.00	\$0.00	\$0.00
834	4-25	WEEKLY	\$36,980.00	6/18/2025	6/30/2027		\$0.00	\$0.00	\$0.00
835	7-25	FLINK	\$10,350.00	7/7/2025	6/30/2027	\$1,769.30	\$4,015.07	\$2,542.70	-\$1,472.37
836	9-24	WEEKLY	\$34,063.30	6/18/2025	6/30/2027		\$0.00	\$0.00	\$0.00
755		FIREWOOD				\$20.00	\$144.66	\$144.66	
Total Active Contract Value			\$972,833.55	Payments Received This Month:			\$1,789.30		
						\$ RECEIVED CURRENT MONTH			
2025 Budgeted Total Revenues						\$400,000	Jobs Finished		
2025 Total County Forestry Revenues this month (90%)						\$1,610.37	Jobs Started		
2025 Total Township Revenues this month (10%):						\$178.93	Jobs Continuing/Reactivated		
							Jobs Gone Inactive		
2025 TOTAL NET FORESTRY REVENUE TO DATE:					\$202,161.72				

**WOOD COUNTY PARKS & FORESTRY DEPARTMENT
REVENUE SUMMARY 2025**

September Revenue - October HIRC

BUDGETED REVENUES 2025	46721	FEES	YTD REVENUE	YTD REVENUE	SEP REV	SEP REV	ACTUAL REV
	SOURCE		2025	2024	2025	2024	2024
\$ 612,000.00	Camping Reservations	\$10 Resv. Fee+/\$21/\$26/\$29/\$36	\$559,726.33	\$ 493,204.33	\$77,403.74	\$ 60,870.51	\$ 559,084.56
\$ 45,000.00	Campground Firewood Sales	\$7 per rack	\$34,035.81	\$ 34,595.60	\$5,531.64	\$ 5,231.38	\$ 39,888.11
\$ 10,000.00	Ice	\$4 (small) /\$7 (large)	\$6,636.80	\$ 7,555.29	\$841.79	\$ 944.99	\$ 7,887.62
\$ 3,900.00	Non-Camper Dump Station	\$20	\$1,852.43	\$ 2,197.36	\$180.09	\$ 151.00	\$ 2,905.41
\$ 400.00	Camper Storage	\$20/wk - \$300/mo	\$0.00	\$ 93.46	\$0.00	\$ -	\$ 99.87
\$ 900.00	Washer/Dryer/Showers	\$2 wash / \$2 dry/\$1 Laundry Pods	\$636.49	\$ 707.11	\$99.29	\$ 139.34	\$ 802.85
\$ 59,000.00	Shelters Enclosed	Various Fees based on 4 or 8 hrs or all day.	\$45,460.96	\$ 48,349.04	\$5,070.10	\$ 4,655.96	\$ 62,254.51
\$ 13,000.00	Shelters - Open	Various Fees based on location of shelter.	\$13,023.51	\$ 11,788.15	\$183.15	\$ 411.81	\$ 12,862.13
\$ 3,000.00	General Park User Fees (Use of open areas within parks)	\$75 / \$10 per picnic table	\$1,109.00	\$ 450.24	\$0.00	\$ -	\$ 450.24
\$ 38,000.00	Powers Bluff Winter Recreation Tickets, Parties, Rentals & Concessions	\$13/\$22/\$515/\$655/\$515/\$725/\$865	\$13,987.01	\$ 1,824.33	\$0.00	\$ 94.79	\$ 1,824.33
\$ 5,000.00	Trail Passes (Ski/Snowshoe/Multi-Use)	\$8/daily; \$30/annual; \$60/family	\$2,708.33	\$ 4,116.45	\$245.58	\$ 289.49	\$ 4,936.78
\$ 8,500.00	Disc Golf	\$3 / \$5 / \$25 / \$50	\$3,651.46	\$ 4,338.65	\$280.39	\$ 437.55	\$ 4,677.66
\$ 500.00	Parks Pulpwood	Market Price	\$0.00	\$ -	\$0.00	\$ -	\$ -
\$ 25,000.00	Boat Launch	\$25/annual; \$7/daily	\$21,741.82	\$ 23,850.94	\$972.08	\$ 1,109.49	\$ 24,755.49
\$ 17,000.00	Miscellaneous		\$4,136.60	\$ 9,074.77	\$334.47	\$ 2,307.39	\$ 19,360.22
\$ 8,800.00	Gift Certificates	Gift Certificates	\$0.00	\$ 241.69	\$0.00	\$ -	\$ 9,035.75
\$ 850,000.00			\$708,706.55	\$642,387.41	\$91,142.32	\$76,643.70	\$ 750,825.53
\$ 400,000.00	46813 - Timber Sales & Wood Cutting (90%/County & 10%/Townships) Monthly totals = NET Revenue	CONTRACTED	\$203,338.34	\$ 302,058.08	\$1,610.37	\$ 1,101.28	\$ 377,740.88
\$ 1,250,000.00		TOTAL REVENUE:	\$912,044.89	\$944,445.49	\$92,752.69	\$77,744.98	\$1,128,566.41

Committee Report

County of Wood

Report of claims for: Parks & Forestry

For the period of: September 2025 (Oct HIRC)

For the range of vouchers: 21250815 - 21250919

Voucher	Vendor Name	Nature of Claim	Doc Date	Amount	Paid
21250815	ALLIANT ENERGY/ WP&L	Electric Serv PB New Shop	08/25/2025	\$47.70	P
21250816	ALLIANT ENERGY/ WP&L	Electric Serv PB Trailhead Slt	08/25/2025	\$18.81	P
21250817	HOME CITY ICE COMPANY THE	Ice for SP Campground	08/20/2025	\$223.70	P
21250818	HOME CITY ICE COMPANY THE	Ice for CP Campground	08/20/2025	\$312.43	P
21250819	HOME CITY ICE COMPANY THE	Ice for DP Campground	08/20/2025	\$286.60	P
21250820	MENARDS-MARSHFIELD	PB Property Fence, NP build sp	08/18/2025	\$1,019.36	P
21250821	STERNWEIS AND SONS INC	DP Shelter Concrete Approach	08/21/2025	\$1,208.00	P
21250822	ACE HARDWARE	CP Equip Supplies	08/19/2025	\$99.99	P
21250823	ACE HARDWARE	CP Gen Supplies	08/19/2025	\$1.58	P
21250824	NUTRIEN AG SOLUTIONS	Forestry Site Prep	08/21/2025	\$810.00	P
21250825	NUTRIEN AG SOLUTIONS	Forestry Site Prep	08/25/2025	\$160.05	P
21250826	FORST AUTO REPAIR LLC	2016 Chevy Silverado	08/27/2025	\$192.32	P
21250827	HAAS BUILDERS SUPPLY INC	DP Lumber for concrete forms	08/19/2025	\$112.84	P
21250828	HAAS BUILDERS SUPPLY INC	CP Roofing Supplies	08/21/2025	\$936.64	P
21250829	HOME CITY ICE COMPANY THE	Ice for NP Campground 302152	08/20/2025	\$437.00	P
21250830	MENARDS-MARSHFIELD	PB Property Fence, NP maint sp	08/22/2025	\$254.51	P
21250831	NAPA CENTRAL WI AUTO PARTS	filter #534	08/18/2025	\$13.49	P
21250832	NAPA CENTRAL WI AUTO PARTS	SP Equip Supplies	08/19/2025	\$108.39	P
21250833	NAPA CENTRAL WI AUTO PARTS	SP Equip Supplies	08/25/2025	\$69.99	P
21250834	OAKDALE ELECTRIC CO	Electric Serv DP Beach house	09/02/2025	\$46.02	P
21250835	OAKDALE ELECTRIC CO	Electric Serv DP ATV	09/02/2025	\$120.23	P
21250836	OAKDALE ELECTRIC CO	Electric Serv DP Dam Area	09/02/2025	\$65.42	P
21250837	OAKDALE ELECTRIC CO	Electric SErv DP Loop 3	09/02/2025	\$66.97	P
21250838	OAKDALE ELECTRIC CO	Electric Serv DP Shelter Area	09/02/2025	\$55.93	P
21250839	OAKDALE ELECTRIC CO	Electric Serv DP Loop 2	09/02/2025	\$612.49	P
21250840	OAKDALE ELECTRIC CO	Electric Serv DP Smitty Storag	09/02/2025	\$50.47	P
21250841	OAKDALE ELECTRIC CO	Electric Serv DP Group Sites	09/02/2025	\$202.79	P
21250842	OAKDALE ELECTRIC CO	Electric Serv DP Host FHU	09/02/2025	\$486.88	P
21250843	OAKDALE ELECTRIC CO	Electric Serv DP Loop 1 Sites	09/02/2025	\$811.94	P
21250844	OAKDALE ELECTRIC CO	Electric Serv DP Cabin	09/02/2025	\$136.30	P
21250845	OAKDALE ELECTRIC CO	Electric Serv DP Loop 3	09/02/2025	\$427.28	P
21250846	OAKDALE ELECTRIC CO	Electric Serv DP Shop	09/02/2025	\$224.27	P
21250847	RAPIDS RENTAL & SUPPLY	NP Equip Repair	08/18/2025	\$127.47	P
21250848	RAPIDS RENTAL & SUPPLY	SP Equip Repair	08/20/2025	\$201.96	P
21250849	STERNWEIS AND SONS INC	DP Shelter Concrete	08/27/2025	\$1,208.00	P
21250850	WATER WORKS & LIGHTING COMM	Electric Serv SP 1st Loop	08/27/2025	\$1,042.99	P
21250851	WATER WORKS & LIGHTING COMM	Electric Serv SP 2nd Loop	08/27/2025	\$659.95	P
21250852	WATER WORKS & LIGHTING COMM	Electric Serv SP 3rd Loop	08/27/2025	\$517.67	P
21250853	WATER WORKS & LIGHTING COMM	Electric Serv SP Ranger/Host	08/27/2025	\$404.68	P

Parks & Forestry - September 2025 (Oct HIRC)

21250815 - 21250919

21250854	WATER WORKS & LIGHTING COMM	Electric Serv SP Showers	08/27/2025	\$294.28	P
21250855	WATER WORKS & LIGHTING COMM	Electric Serv RSBP	08/27/2025	\$236.14	P
21250856	WATER WORKS & LIGHTING COMM	Electric Serv SP Shop	08/27/2025	\$84.02	P
21250857	WATER WORKS & LIGHTING COMM	Electric Serv SP Storm Shelter	08/27/2025	\$79.91	P
21250858	WATER WORKS & LIGHTING COMM	Electric Serv Sp Stone & Open	08/27/2025	\$76.90	P
21250859	WATER WORKS & LIGHTING COMM	Electric Serv SP WSBP	08/27/2025	\$63.87	P
21250860	WATER WORKS & LIGHTING COMM	Electric Serv Sp L2 H Panel	08/27/2025	\$47.96	P
21250861	WATER WORKS & LIGHTING COMM	Electric Serv SP Dam	09/02/2025	\$26.97	P
21250862	ALLIANT ENERGY/ WP&L	Electric Serv PB OG Shop	09/04/2025	\$63.48	P
21250863	ALLIANT ENERGY/ WP&L	Electric Serv Nepco	09/04/2025	\$343.72	P
21250864	ALLIANT ENERGY/ WP&L	Electric Serv ATV IUA	09/04/2025	\$28.39	P
21250865	ALLIANT ENERGY/ WP&L	Electric Serv NP Suspension Br	09/04/2025	\$366.09	P
21250866	ALLIANT ENERGY/ WP&L	NP Hawthorne Hill Sites	09/04/2025	\$370.53	P
21250867	ALLIANT ENERGY/ WP&L	Electric Serv NP Riverside Cam	09/04/2025	\$219.40	P
21250868	ALLIANT ENERGY/ WP&L	Electric Serv NP Ranger/Host	09/04/2025	\$223.29	P
21250869	ALLIANT ENERGY/ WP&L	Electric Serv NP Shelter Area	09/04/2025	\$79.06	P
21250870	ALLIANT ENERGY/ WP&L	Electric Serv NP Shop	09/04/2025	\$209.58	P
21250871	ALLIANT ENERGY/ WP&L	Electric Serv NP Lower Shwr	09/04/2025	\$153.71	P
21250872	ALLIANT ENERGY/ WP&L	Electric Serv NP New Shower	09/04/2025	\$797.30	P
21250873	HARTERS FOX VALLEY DISPOSAL LLC	monthly garbage/recycle CP	09/01/2025	\$426.00	P
21250874	SOLARUS	Security Camera SP/CP	09/16/2025	\$149.98	P
21250875	WE ENERGIES	Gas Service SP Cabin, Showers	08/29/2025	\$36.93	P
21250876	WE ENERGIES	Natural Gas Storm Shelter	08/29/2025	\$28.25	P
21250877	WE ENERGIES	Gas Serv for SP Shop	09/02/2025	\$9.57	P
21250878	ALLIANT ENERGY/ WP&L	Electric Serv Cera Park	09/15/2025	\$1,353.81	P
21250879	ALLIED COOPERATIVE	Diesel #609	08/19/2025	\$252.48	P
21250880	AMAZON CAPITAL SERVICES	chainsaw supplies	09/05/2025	\$77.62	P
21250881	AMERICAN DRONE LLC	Forestry Site Prep Drone Appli	09/14/2025	\$3,180.00	P
21250882	BUDS CORNER MART	Gas for Vehicles &Equip SP	08/31/2025	\$956.78	P
21250883	CINTAS CORPORATION	Camp Rangers Uniform Cleaning	08/01/2025	\$106.37	P
21250884	CINTAS CORPORATION	Camp Rangers Uniform Cleaning	08/08/2025	\$106.37	P
21250885	CINTAS CORPORATION	Camp Rangers Uniform Cleaning	08/15/2025	\$106.37	P
21250886	CINTAS CORPORATION	Camp Rangers Uniform Cleaning	08/22/2025	\$106.37	P
21250887	CINTAS CORPORATION	Camp Rangers Uniform Cleaning	08/29/2025	\$106.37	P
21250888	DOINE EXCAVATING INC	Pea Gravel PB Shop	08/13/2025	\$639.00	P
21250889	FERGUSON ENTERPRISES LLC	Buiding Repair Supplies SP	08/14/2025	\$65.98	P
21250890	FERGUSON ENTERPRISES LLC	Bulding Repair Supplies SP	09/05/2025	\$75.68	P
21250891	FERGUSON ENTERPRISES LLC	Building Repair Supplies SP	09/05/2025	\$114.00	P
21250892	HILLER'S TRUE VALUE HARDWARE	DP Vehicle & Maint Supplies	08/25/2025	\$41.98	P
21250893	HOME DEPOT CREDIT SERVICES	Aug Park Supplies	09/05/2025	\$279.92	P
21250894	INSIGHT FS	Bullzeye	08/27/2025	\$54.26	P
21250895	INSIGHT FS	Unleaded NP	08/27/2025	\$859.24	P
21250896	INSIGHT FS	Diesel NP	08/27/2025	\$504.19	P
21250897	JEWELL ASSOCIATES ENGINEERS INC	NP Shelter Bridge Replacement	09/04/2025	\$3,300.00	P
21250898	LAKESIDE OASIS LLC	Gas &Diesel Dexter & Forestry	08/31/2025	\$1,157.01	P
21250899	MENARDS-MARSHFIELD	PB Shelter Tile	09/03/2025	\$159.98	P
21250900	MISSISSIPPI WELDERS SUPPLY CO INC	PB Oxygen cyl rental	08/31/2025	\$21.39	P
21250901	PITTSVILLE FARM & HOME CENTER	DPShop Supplies	08/02/2025	\$7.49	P

Parks & Forestry - September 2025 (Oct HIRC)

21250815 - 21250919

21250902	PITTSVILLE FARM & HOME CENTER	DP Shop Supplies	08/14/2025	\$19.98	P
21250903	PITTSVILLE FARM & HOME CENTER	DP Shop Supplies	08/19/2025	\$37.96	P
21250904	POMP'S TIRE SERVICE INC - Milw	#565 lawn mower tire	08/11/2025	\$119.96	P
21250905	POWER PAC INC	DP Weedie Parts	08/01/2025	\$13.73	P
21250906	POWER PAC INC	DP Weedie Parts	08/05/2025	\$25.20	P
21250907	POWER PAC INC	SP Equip Supplies	08/18/2025	\$319.41	P
21250908	POWER PAC INC	SP Equip Supplies	08/18/2025	\$139.50	P
21250909	QUALITY DOOR & HARDWARE	Cera Park Keying	09/10/2025	\$1,116.09	P
21250910	UNITED RENTALS NORTH AMERICA INC	Brush Mower Attachment	08/20/2025	\$1,130.16	P
21250911	WASTE MANAGEMENT	monthly garbage/recycle	09/04/2025	\$2,022.63	P
21250912	WE ENERGIES	Natural Gas PB Shop	09/11/2025	\$12.47	P
21250913	WEICHELTRUCKING & EXCAVATING	Granite - Forestry Roads	09/09/2025	\$1,480.00	P
21250914	WEICHELTRUCKING & EXCAVATING	Granite - Forestry Roads	09/09/2025	\$1,480.00	P
21250915	WISCONSIN VALLEY BUILDING PRODUCTS	Hex Impact Driver	08/24/2025	\$284.90	P
21250916	WISCONSIN VALLEY BUILDING PRODUCTS	NP Beach House Repair	08/27/2025	\$148.08	P
21250917	WISCONSIN COATING SPECIALISTS LLC	Shower Buiding Floor Coating	09/05/2025	\$1,250.00	P
21250918	WOLOSEK LANDSCAPING	SP Landscaping	08/31/2025	\$123.98	P
21250919	WOOD COUNTY REGISTER OF DEEDS	Holding Tank PB Trailhead Shlt	08/06/2025	\$30.00	P

Grand Total:**\$41,585.15**Signatures

Committee Chair:

Committee Member:

Committee Member:

Committee Member:

Committee Member:

Committee Member:

Committee Member:

Committee Member:

Committee Member:

2025 Parks, Forestry & Highway Tour

October 2, 2025

Immediately following HIRC meeting, beginning at 8:00 am, at WR Highway Shop

Scheduled Stops (if weather and time permit)

1. Leaving from WR Hwy Shop
2. Marsh Road land trade proposal
3. Wood County Rifle and Pistol Club range
4. Range Road – ATV Intensive Use Area trail construction project
5. Hwy 54 Accessible hunting blinds
6. Dexter Park beach house construction project
7. North Park bridge replacement and campground exit road projects
8. Cty Hwy BB/ STH 10 intersection
9. Cty Hwy T
10. Powers Bluff shop, trailhead shelter, and old shop removal projects
11. Cera Park projects
12. South Park 2nd shower building project
13. Return to WR Hwy Shop